

InfiniRack Data Center Cabinet

Endlessly Customizable

InfiniRack was born to address the demands of modern data center environments. With over a million possible configurations, excellent load ratings, maximum internal available space, superior airflow and cable management, and much more, it offers a better solution for an industry that's rapidly evolving. It's the new standard for data center cabinets.



Configured-to-Order

Every InfiniRack is configured based on your unique order. There's no such thing as a "standard" unit. The standard is what you make it. All cabinets ship preassembled and with selected accessories installed.



Maximum Internal Usable Space

With a low-profile frame design and integrated dual PDU channels, InfiniRacks are engineered to maximize internal usable space.



Excellent Load Ratings

Featuring static load ratings of 4,000 lb (1814 kg) and dynamic load ratings of 3,000 lb (1361 kg), InfiniRacks are designed to accommodate ever-growing densities.



Superior Cable Management

Multiple vertical cable management options are available, some of which feature toolless installation and removal. Pro versions include a lashing panel to relieve stress on cable terminations and hinged covers to keep it all concealed.



Recessed PDU Mounting

Dual PDU channels are integrated into the frame's rear corners, allowing for recessed PDU mounting, maximizing access to rack mounted equipment.



Efficient AirFlow Management

Brush panels allow cable passthrough while mitigating leakage of hot exhaust air, an optional air dam kit seals gaps around the perimeter of the front mounting rails, and 31.5" (800 mm) wide InfiniRacks include grommets in all rail openings.





New Frame Architecture

New frame architecture to support robust load ratings: 4,000 lb (1814 kg) static, 3,000 lb (1361 kg) dynamic (rolling casters).

Top Panel Brushes

Brush-sealed cable openings on the top panel are included as standard, ensuring easy cable passthrough while maintaining optimal airflow.

Dual Recessed PDU Channels

Integrated dual recessed PDU channels address an industry-wide problem of PDUs interfering with 19" EIA spacing in 23.6" (600 mm) wide cabinets.

Vertical Cable Managers

The new finger-style vertical cable managers (short or long fingers) feature toolless installation and removal. The Pro options include a lashing panel and hinge cover.

Front-to-Rear Cable Trough

The front-to-rear cable trough provides a dedicated cable pathway through openings in the equipment mounting rails in 31.5" (800 mm) wide cabinets.

Multiple Door Lock Options

Keep your cabinet secure with a premium swing handle with keyed entry, combination, or electronic door lock options to suit your preference.

Reversible Doors with Optimized Airflow

The high-quality, rigid front and split rear doors feature an 80% open hexagonal perforation to maximize airflow. The quick-release hinges allow for easy door removal and reversibility.

Air Dam Kit

Maximize your thermal efficiency with the optional air dam kit that seals the perimeter of the front pair of equipment mounting rails.

Adjustable Mounting Rails

The equipment mounting rails are easily adjusted, providing the ability to quickly reposition from front to back. Frame interior includes depth markings for reference.

Heavy-Duty Casters and Leveling Feet

Four heavy-duty swivel casters come standard with InfiniRack, providing easy transport when not on leveling feet.

Certifications

UL Standards	UL2416
Protection Rating	IP20
Specification	EIA-310
Compliance	RoHS

Use the part number matrix below to build out your InfiniRack cabinet configuration.

Step 1 - Choose size					Step 2 - Choose Configuration					Step 3 - Choose Options																																																																																																																						
IR	-	6	12	42	-	A	A	1	2	B	-	0	0	0	0	0	1																																																																																																															
Prefix		Width	Depth	Height		Doors	Locks	Top Panel	Side Panel	Color		Airflow Mgmt.	Vertical Cable Manager Front-Left	Vertical Cable Manager Front-Right	Vertical Cable Manager Rear-Left	Vertical Cable Manager Rear-Right	Standard Pallet																																																																																																															
<div><div><div><div>Width</div><table><tr><th>in</th><th>mm</th><th>value</th></tr><tr><td>23.6</td><td>600</td><td>6</td></tr><tr><td>31.5</td><td>800</td><td>8</td></tr></table></div><div><div>Depth (frame)</div><table><tr><th>in</th><th>mm</th><th>value</th></tr><tr><td>39.4</td><td>1000</td><td>10</td></tr><tr><td>43.3</td><td>1100</td><td>11</td></tr><tr><td>47.2</td><td>1200</td><td>12</td></tr></table></div><div><div>Height</div><table><tr><th>in</th><th>mm</th><th>RU</th><th>value</th></tr><tr><td>78.8</td><td>2002</td><td>42</td><td>42</td></tr><tr><td>83.9</td><td>2131</td><td>45</td><td>45</td></tr><tr><td>89.3</td><td>2268</td><td>48</td><td>48</td></tr><tr><td>96.3</td><td>2446</td><td>52</td><td>52</td></tr></table></div><div><div>Doors</div><table><tr><th colspan="2">Doors</th></tr><tr><th>Configuration</th><th>value</th></tr><tr><td>None</td><td>0</td></tr><tr><td>Single Perf Front/Split Perf Rear</td><td>A</td></tr><tr><td>No Front/Split Perf Rear</td><td>B</td></tr></table></div><div><div>Locks</div><table><tr><th colspan="2">Locks</th></tr><tr><th>Configuration</th><th>value</th></tr><tr><td>None</td><td>0</td></tr><tr><td>Keyed</td><td>A</td></tr><tr><td>Combination</td><td>B</td></tr></table></div><div><div>Top Panel</div><table><tr><th colspan="2">Top Panel</th></tr><tr><th>Configuration</th><th>value</th></tr><tr><td>None</td><td>0</td></tr><tr><td>Top Panel with Four Brush-Sealed Cable Openings</td><td>1</td></tr></table></div><div><div>Side Panel</div><table><tr><th colspan="2">Side Panel</th></tr><tr><th>Configuration</th><th>value</th></tr><tr><td>None</td><td>0</td></tr><tr><td>1 Side Panel</td><td>1</td></tr><tr><td>2 Side Panels</td><td>2</td></tr></table></div><div><div>Color</div><table><tr><th colspan="2">Color</th></tr><tr><th>Configuration</th><th>value</th></tr><tr><td>Black</td><td>B</td></tr><tr><td>White</td><td>W</td></tr></table></div><div><div>Airflow Management</div><table><tr><th colspan="2">Airflow Management</th></tr><tr><th>Configuration</th><th>value</th></tr><tr><td>No Air Dam, No Bottom Panel</td><td>0</td></tr><tr><td>Air Dam Only</td><td>1</td></tr><tr><td>Air Dam and Bottom Panel</td><td>2</td></tr></table></div><div><div>Vert. Cable Mgmt., Equip. Rails</div><table><tr><th colspan="2">Vert. Cable Mgmt., Equip. Rails</th></tr><tr><th>Configuration</th><th>value</th></tr><tr><td>None</td><td>0</td></tr><tr><td>Short Finger, Basic</td><td>A</td></tr><tr><td>Long Finger, Basic</td><td>B</td></tr><tr><td>*Short Finger, Pro</td><td>C</td></tr><tr><td>*Long Finger, Pro</td><td>D</td></tr></table></div></div></div>																		in	mm	value	23.6	600	6	31.5	800	8	in	mm	value	39.4	1000	10	43.3	1100	11	47.2	1200	12	in	mm	RU	value	78.8	2002	42	42	83.9	2131	45	45	89.3	2268	48	48	96.3	2446	52	52	Doors		Configuration	value	None	0	Single Perf Front/Split Perf Rear	A	No Front/Split Perf Rear	B	Locks		Configuration	value	None	0	Keyed	A	Combination	B	Top Panel		Configuration	value	None	0	Top Panel with Four Brush-Sealed Cable Openings	1	Side Panel		Configuration	value	None	0	1 Side Panel	1	2 Side Panels	2	Color		Configuration	value	Black	B	White	W	Airflow Management		Configuration	value	No Air Dam, No Bottom Panel	0	Air Dam Only	1	Air Dam and Bottom Panel	2	Vert. Cable Mgmt., Equip. Rails		Configuration	value	None	0	Short Finger, Basic	A	Long Finger, Basic	B	*Short Finger, Pro	C	*Long Finger, Pro	D
in	mm	value																																																																																																																														
23.6	600	6																																																																																																																														
31.5	800	8																																																																																																																														
in	mm	value																																																																																																																														
39.4	1000	10																																																																																																																														
43.3	1100	11																																																																																																																														
47.2	1200	12																																																																																																																														
in	mm	RU	value																																																																																																																													
78.8	2002	42	42																																																																																																																													
83.9	2131	45	45																																																																																																																													
89.3	2268	48	48																																																																																																																													
96.3	2446	52	52																																																																																																																													
Doors																																																																																																																																
Configuration	value																																																																																																																															
None	0																																																																																																																															
Single Perf Front/Split Perf Rear	A																																																																																																																															
No Front/Split Perf Rear	B																																																																																																																															
Locks																																																																																																																																
Configuration	value																																																																																																																															
None	0																																																																																																																															
Keyed	A																																																																																																																															
Combination	B																																																																																																																															
Top Panel																																																																																																																																
Configuration	value																																																																																																																															
None	0																																																																																																																															
Top Panel with Four Brush-Sealed Cable Openings	1																																																																																																																															
Side Panel																																																																																																																																
Configuration	value																																																																																																																															
None	0																																																																																																																															
1 Side Panel	1																																																																																																																															
2 Side Panels	2																																																																																																																															
Color																																																																																																																																
Configuration	value																																																																																																																															
Black	B																																																																																																																															
White	W																																																																																																																															
Airflow Management																																																																																																																																
Configuration	value																																																																																																																															
No Air Dam, No Bottom Panel	0																																																																																																																															
Air Dam Only	1																																																																																																																															
Air Dam and Bottom Panel	2																																																																																																																															
Vert. Cable Mgmt., Equip. Rails																																																																																																																																
Configuration	value																																																																																																																															
None	0																																																																																																																															
Short Finger, Basic	A																																																																																																																															
Long Finger, Basic	B																																																																																																																															
*Short Finger, Pro	C																																																																																																																															
*Long Finger, Pro	D																																																																																																																															

REAR

CABINET TOP VIEW

FLFR

FRONT

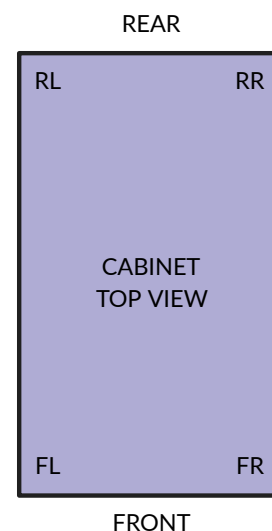

Notes

*Not compatible with 23.6" W (600 mm) frame width.

31.5" W (800 mm) wide cabinets include grommet-sealed cable openings in the equipment mounting rails as standard.

Locations of installed vertical cable managers are referenced as viewed from the front of the cabinet.

Vertical cable managers can be installed on any of the four equipment mounting rails.

Basic vertical cable managers include a finger section only.

Pro vertical cable managers include a finger section, lashing panel, and hinged covers.

Width Options - inches (mm)

in	mm
23.6"	600 mm
31.5"	800 mm

Height Options - inches (mm)

RU	*Overall	Frame Only
42	78.8" (2001 mm)	76.6" (1946 mm)
45	84.0" (2135 mm)	81.9" (2079 mm)
48	89.3" (2268 mm)	87.1" (2213 mm)
52	96.3" (2446 mm)	94.1" (2391 mm)

*Overall height measurements include casters and leveling feet.

Depth Options (frame only) - inches (mm)

in	mm	Rail Max - in (mm)	With Doors - in (mm)
31.5"	800 mm	24.0" (610 mm)	34.7" (882 mm)
39.4"	1000 mm	31.9" (810 mm)	42.6" (1082 mm)
43.3"	1100 mm	35.8" (910 mm)	46.5" (1182 mm)
47.2"	1200 mm	39.8" (1010 mm)	50.5" (1282 mm)

Cable Managers - Rail Setback in (mm)

Basic Short 4.5" (115 mm)

Basic Long 7.1" (178 mm)

Pro Short 5.0" (125 mm)

Pro Long 7.5" (188mm)

*Rail setback is the minimum mounting depth required for each cable manager.

Dimension Drawings

600 mm Wide Cabinet

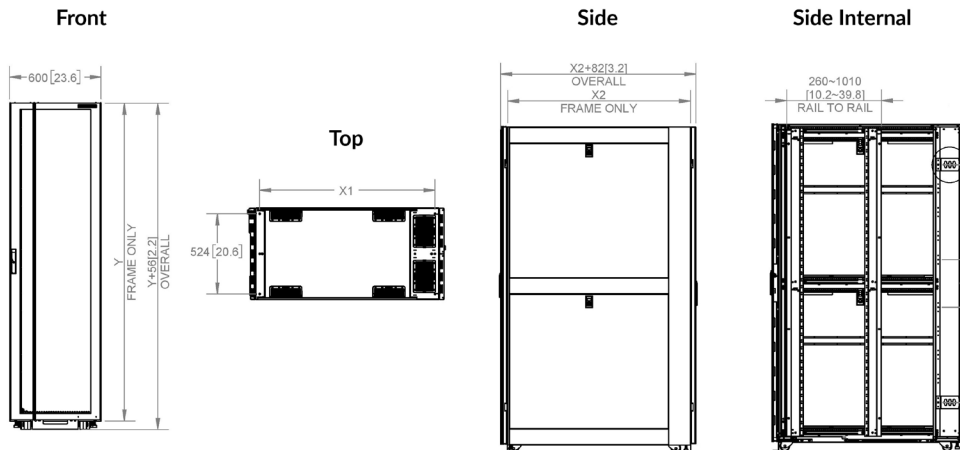

PN	X1	X2	X3	Y
IR-60842	750[29.5]	800[31.5]	630[24.8]	1946[76.6]
IR-60845	750[29.5]	800[31.5]	630[24.8]	2079[81.9]
IR-60848	750[29.5]	800[31.5]	630[24.8]	2212[87.1]
IR-60852	750[29.5]	800[31.5]	630[24.8]	2390[94.1]
IR-61042	950[37.4]	1000[39.4]	830[32.7]	1946[76.6]
IR-61045	950[37.4]	1000[39.4]	830[32.7]	2079[81.9]
IR-61048	950[37.4]	1000[39.4]	830[32.7]	2212[87.1]
IR-61052	950[37.4]	1000[39.4]	830[32.7]	2390[94.1]
IR-61142	1050[41.3]	1100[43.3]	930[36.6]	1946[76.6]
IR-61145	1050[41.3]	1100[43.3]	930[36.6]	2079[81.9]
IR-61148	1050[41.3]	1100[43.3]	930[36.6]	2212[87.1]
IR-61152	1050[41.3]	1100[43.3]	930[36.6]	2390[94.1]
IR-61242	1150[45.3]	1200[47.2]	1030[40.6]	1946[76.6]
IR-61245	1150[45.3]	1200[47.2]	1030[40.6]	2079[81.9]
IR-61248	1150[45.3]	1200[47.2]	1030[40.6]	2212[87.1]
IR-61252	1150[45.3]	1200[47.2]	1030[40.6]	2390[94.1]

800 mm Wide Cabinet

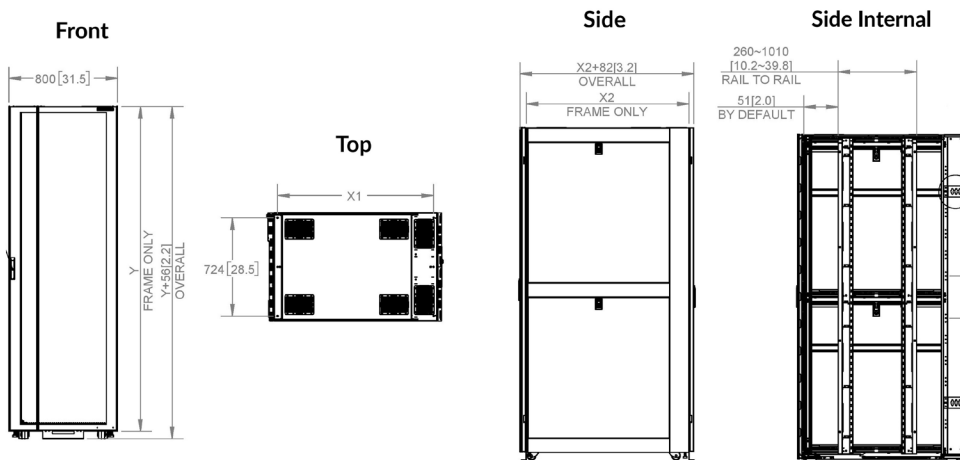

PN	X1	X2	X3	Y
IR-80842	750[29.5]	800[31.5]	630[24.8]	1946[76.6]
IR-80845	750[29.5]	800[31.5]	630[24.8]	2079[81.9]
IR-80848	750[29.5]	800[31.5]	630[24.8]	2212[87.1]
IR-80852	750[29.5]	800[31.5]	630[24.8]	2390[94.1]
IR-81042	950[37.4]	1000[39.4]	830[32.7]	1946[76.6]
IR-81045	950[37.4]	1000[39.4]	830[32.7]	2079[81.9]
IR-81048	950[37.4]	1000[39.4]	830[32.7]	2212[87.1]
IR-81052	950[37.4]	1000[39.4]	830[32.7]	2390[94.1]
IR-81142	1050[41.3]	1100[43.3]	930[36.6]	1946[76.6]
IR-81145	1050[41.3]	1100[43.3]	930[36.6]	2079[81.9]
IR-81148	1050[41.3]	1100[43.3]	930[36.6]	2212[87.1]
IR-81152	1050[41.3]	1100[43.3]	930[36.6]	2390[94.1]
IR-81242	1150[45.3]	1200[47.2]	1030[40.6]	1946[76.6]
IR-81245	1150[45.3]	1200[47.2]	1030[40.6]	2079[81.9]
IR-81248	1150[45.3]	1200[47.2]	1030[40.6]	2212[87.1]
IR-81252	1150[45.3]	1200[47.2]	1030[40.6]	2390[94.1]

Available in Black or White; In PN X = Black (B) or White (W) where applicable



Vertical Cable Manager - Pro

- Configure cable manager with InfiniRack (recommended) or order separately
- Short and long finger options
- Finger openings are spaced in 1U increments for optimal cable management
- Includes lashing panel and removable hinged covers
- Lashing panel attaches to cabinet frame
- Only compatible with 800 mm wide cabinet

Part Number	Standard Description
E010011-00X	Vertical Cable Manager for InfiniRack Cabinet; for 31.5" W (800 mm) x 42U Cabinets; Pro Version; Short Finger
E010011-01X	Vertical Cable Manager for InfiniRack Cabinet; for 31.5" W (800 mm) x 45U Cabinets; Pro Version; Short Finger
E010011-02X	Vertical Cable Manager for InfiniRack Cabinet; for 31.5" W (800 mm) x 48U Cabinets; Pro Version; Short Finger
E010011-03X	Vertical Cable Manager for InfiniRack Cabinet; for 31.5" W (800 mm) x 52U Cabinets; Pro Version; Short Finger
E010011-04X	Vertical Cable Manager for InfiniRack Cabinet; for 31.5" W (800 mm) x 42U Cabinets; Pro Version; Long Finger
E010011-05X	Vertical Cable Manager for InfiniRack Cabinet; for 31.5" W (800 mm) x 45U Cabinets; Pro Version; Long Finger
E010011-06X	Vertical Cable Manager for InfiniRack Cabinet; for 31.5" W (800 mm) x 48U Cabinets; Pro Version; Long Finger
E010011-07X	Vertical Cable Manager for InfiniRack Cabinet; for 31.5" W (800 mm) x 52U Cabinets; Pro Version; Long Finger



Vertical Cable Manager - Basic

- Configure cable manager with InfiniRack (recommended) or order separately
- Short and long finger options
- Finger openings are spaced in 1U increments for optimal cable management
- Attach to vertical equipment mounting rails
- Toolless install and removal
- *Available in black only

Part Number	Standard Description
E010010-00B	Vertical Cable Manager for InfiniRack Cabinet; 42U; Basic; Short Finger; Black
E010010-01B	Vertical Cable Manager for InfiniRack Cabinet; 45U; Basic; Short Finger; Black
E010010-02B	Vertical Cable Manager for InfiniRack Cabinet; 48U; Basic; Short Finger; Black
E010010-03B	Vertical Cable Manager for InfiniRack Cabinet; 52U; Basic; Short Finger; Black
E010010-04B	Vertical Cable Manager for InfiniRack Cabinet; 42U; Basic; Long Finger; Black
E010010-05B	Vertical Cable Manager for InfiniRack Cabinet; 45U; Basic; Long Finger; Black
E010010-06B	Vertical Cable Manager for InfiniRack Cabinet; 48U; Basic; Long Finger; Black
E010010-07B	Vertical Cable Manager for InfiniRack Cabinet; 52U; Basic; Long Finger; Black

Available in Black or White; In PN X = Black (B) or White (W) where applicable



Lashing Panel

- Supports cable bundles and relieves stress on cable terminations
- Included with Pro vertical cable managers
- Attaches to the cabinet frame and its position is adjustable front-to-rear

Part Number	Standard Description
E010013-00X	Cable Lashing Panel for InfiniRack Cabinet; 5.6" W (143 mm); 42U
E010013-01X	Cable Lashing Panel for InfiniRack Cabinet; 5.6" W (143 mm); 45U
E010013-02X	Cable Lashing Panel for InfiniRack Cabinet; 5.6" W (143 mm); 48U
E010013-03X	Cable Lashing Panel for InfiniRack Cabinet; 5.6" W (143 mm); 52U
E010013-04X	Cable Lashing Panel for InfiniRack Cabinet; 8.1" W (206 mm); 42U
E010013-05X	Cable Lashing Panel for InfiniRack Cabinet; 8.1" W (206 mm); 45U
E010013-06X	Cable Lashing Panel for InfiniRack Cabinet; 8.1" W (206 mm); 48U
E010013-07X	Cable Lashing Panel for InfiniRack Cabinet; 8.1" W (206 mm); 52U



Front-To-Rear Cable Trough

- Provides a 3.4"W x 2.3"H (87 mm x 59 mm) front-to-rear dedicated cable pathway
- Telescoping adjustability from front-to-rear
- Attaches to rail openings present in 31.5" (800 mm) wide cabinets

Part Number	Standard Description
E010012-00B	Front-to-Rear Cable Trough for InfiniRack Cabinet; for 31.5" W (800 mm) Cabinets; Sold Each; Black
E010012-00W	Front-to-Rear Cable Trough for InfiniRack Cabinet; for 31.5" W (800 mm) Cabinets; Sold Each; White



Cable Pathway Support Kit

- Support cable pathway from the top of the InfiniRack cabinet
- Adjustable from front to rear along tracks/pathway aligning with openings in the top panel
- Single-tier or two-tier options
- Adjust the pathway height in 1" increments for cable ladder height

Part Number	Standard Description
E010049-010	Cable Ladder Support Kit for InfiniRack Cabinet, Single Tier, 6" and 12"H (150 mm and 300 mm H), Black
E010049-020	Cable Ladder Support Kit for InfiniRack Cabinet, Two Tier, 6" and 12"H (150 mm and 300 mm H), Black

Available in Black or White; In PN X = Black (B) or White (W) where applicable



Side Panels

- Keyed panel latch
- Toolless installation and Removal
- Electrically bonds with the cabinet frame when installed
- Includes two panels; enough to cover one side of one cabinet

Part Number	Standard Description
E010040-01X	Side Panel for InfiniRack Cabinet; for 39.4" D (1000 mm) x 42U Cabinet; 2 pcs per set; Covers one side of one cabinet; Solid; Locking
E010040-02X	Side Panel for InfiniRack Cabinet; for 41.3" D (1100 mm) x 42U Cabinet; 2 pcs per set; Covers one side of one cabinet; Solid; Locking
E010040-03X	Side Panel for InfiniRack Cabinet; for 47.2" D (1200 mm) x 42U Cabinet; 2 pcs per set; Covers one side of one cabinet; Solid; Locking
E010040-05X	Side Panel for InfiniRack Cabinet; for 39.4" D (1000 mm) x 45U Cabinet; 2 pcs per set; Covers one side of one cabinet; Solid; Locking
E010040-06X	Side Panel for InfiniRack Cabinet; for 41.3" D (1100 mm) x 45U Cabinet; 2 pcs per set; Covers one side of one cabinet; Solid; Locking
E010040-07X	Side Panel for InfiniRack Cabinet; for 47.2" D (1200 mm) x 45U Cabinet; 2 pcs per set; Covers one side of one cabinet; Solid; Locking
E010040-09X	Side Panel for InfiniRack Cabinet; for 39.4" D (1000 mm) x 48U Cabinet; 2 pcs per set; Covers one side of one cabinet; Solid; Locking
E010040-10X	Side Panel for InfiniRack Cabinet; for 41.3" D (1100 mm) x 48U Cabinet; 2 pcs per set; Covers one side of one cabinet; Solid; Locking
E010040-11X	Side Panel for InfiniRack Cabinet; for 47.2" D (1200 mm) x 48U Cabinet; 2 pcs per set; Covers one side of one cabinet; Solid; Locking
E010040-13X	Side Panel for InfiniRack Cabinet; for 39.4" D (1000 mm) x 52U Cabinet; 2 pcs per set; Covers one side of one cabinet; Solid; Locking
E010040-14X	Side Panel for InfiniRack Cabinet; for 41.3" D (1100 mm) x 52U Cabinet; 2 pcs per set; Covers one side of one cabinet; Solid; Locking
E010040-15X	Side Panel for InfiniRack Cabinet; for 47.2" D (1200 mm) x 52U Cabinet; 2 pcs per set; Covers one side of one cabinet; Solid; Locking

Bottom Panel

- Configure with InfiniRack (recommended) or order separately
- Seals the bottom of the cabinet to improve airflow efficiency
- Provides cable passthrough through floor
- Available in black and white
- Requires Air Dam Kit



Part Number	Standard Description
E010048-01X	Rear Bottom for InfiniRack,w/ brush, for 23.6"W (600 mm) x 1000mm Depth Cabinet
E010048-02X	Rear Bottom for InfiniRack,w/ brush, for 23.6"W (600 mm) x 1100mm Depth Cabinet
E010048-03X	Rear Bottom for InfiniRack,w/ brush, for 23.6"W (600 mm) x 1200mm Depth Cabinet
E010048-05X	Rear Bottom for InfiniRack,w/ brush, for 31.5"W (800 mm) x 1000mm Depth Cabinet
E010048-06X	Rear Bottom for InfiniRack,w/ brush, for 31.5"W (800 mm) x 1100mm Depth Cabinet
E010048-07X	Rear Bottom for InfiniRack,w/ brush, for 31.5"W (800 mm) x 1200mm Depth Cabinet

Available in Black or White; In PN X = Black (B) or White (W) where applicable



Air Dam Kit

- Configure cable manager with InfiniRack (recommended) or order separately
- Seals perimeter of front equipment mounting rails
- Maximizes airflow efficiency

Part Number	Standard Description
E010030-00X	Air Dam for InfiniRack Cabinet; for 23.6" W (600 mm) x 42U Cabinet
E010030-01X	Air Dam for InfiniRack Cabinet; for 23.6" W (600 mm) x 45U Cabinet
E010030-02X	Air Dam for InfiniRack Cabinet; for 23.6" W (600 mm) x 48U Cabinet
E010030-03X	Air Dam for InfiniRack Cabinet; for 23.6" W (600 mm) x 52U Cabinet
E010030-04X	Air Dam for InfiniRack Cabinet; for 31.5" W (800 mm) x 42U Cabinet
E010030-05X	Air Dam for InfiniRack Cabinet; for 31.5" W (800 mm) x 45U Cabinet
E010030-06X	Air Dam for InfiniRack Cabinet; for 31.5" W (800 mm) x 48U Cabinet
E010030-07X	Air Dam for InfiniRack Cabinet; for 31.5" W (800 mm) x 52U Cabinet



Brush Kit

- Replacement brush for top and bottom panel cable openings
- Half-brush can be used in rail openings of 31.5 in (800 mm) wide cabinets instead of cable grommets for high-density cabling applications.
- UL 94V0 rated materials

Part Number	Standard Description
E010020-00B	Brush Kit for InfiniRack Cabinet; Pair; Black
E010020-05B	Brush Kit for InfiniRack Cabinet; 5 Each; Black



Blanking Panels

- Seals gaps to ensure optimal airflow
- Toolless installation and removal
- Made from UL 94-V0 rated material

Part Number	Standard Description
E010061-10B	Blanking Panel; 1U; 19" EIA; Pack of 10; UL94-V0; Black
E010061-10W	Blanking Panel; 1U; 19" EIA; Pack of 10; UL94-V0; White
E010062-05B	Blanking Panel; 2U; 19" EIA; Pack of 5; UL94-V0; Black
E010062-05W	Blanking Panel; 2U; 19" EIA; Pack of 5; UL94-V0; White



Get in touch today.

Sales Organization Contact Information

Dave Bercovich

Sales Director

dave.bercovich@enconnex.com

+1 (775) 772-6683

Rachel Cross

Regional Sales Manager

rachel.cross@enconnex.com

Isaac Osborne

Inside Sales Representative

isaac.osborne@enconnex.com

InfiniRack:
**Redefining what a data
center cabinet should be.**

Contact us directly.

Or learn more at enconnex.com/infinirack-data-center-cabinet